Company Information

(as used on contracts)

Company Business Name
Company Contact
Title
Address Line 1
Address Line 1
City
State
Zip Code
Office Phone
Fax
Cell Phone
E-Mail address

Company Shipping Address for Design Prints

(for Delivery of Design Prints if different than address above)

Attention
Address Line 1
Address Line 1
City
State
Zip Code

Company Shipping Address for Hardware Pack

(for Delivery of Hardware Pack if different than address above)

Attention
Address Line 1
Address Line 1
City
State
Zip Code

Project Information

Project Name (as to appear on prints)
Address Line 1
Address Line 1
City
State
Zip Code
Project Job Number (optional)
Purchase order Number (optional)

Site Data

Array Location on Property:
Provide Site Map or GPS Coordinates:
Latitude (i.e. 39.711753)
Longitude (i.e. -75.598827)
(Please verify when the your coordinates are entered into Google Earth that the correct array location is displayed)
Inches of North Ground Slope (see sketch for +/-)
Inches of East/West Ground Slope over array width
Presence of Shallow Bedrock (Y/N) and approx depth

Solar Panel Module Information

Module Manufacturer
Complete Model Number
Wattage
Panel Short Side Dimension (xx.xx)"
Panel Long Side Dimension (xx.xx)"
Panel Thickness (xx) mm
(or attach a pdf of the panel spec sheet)

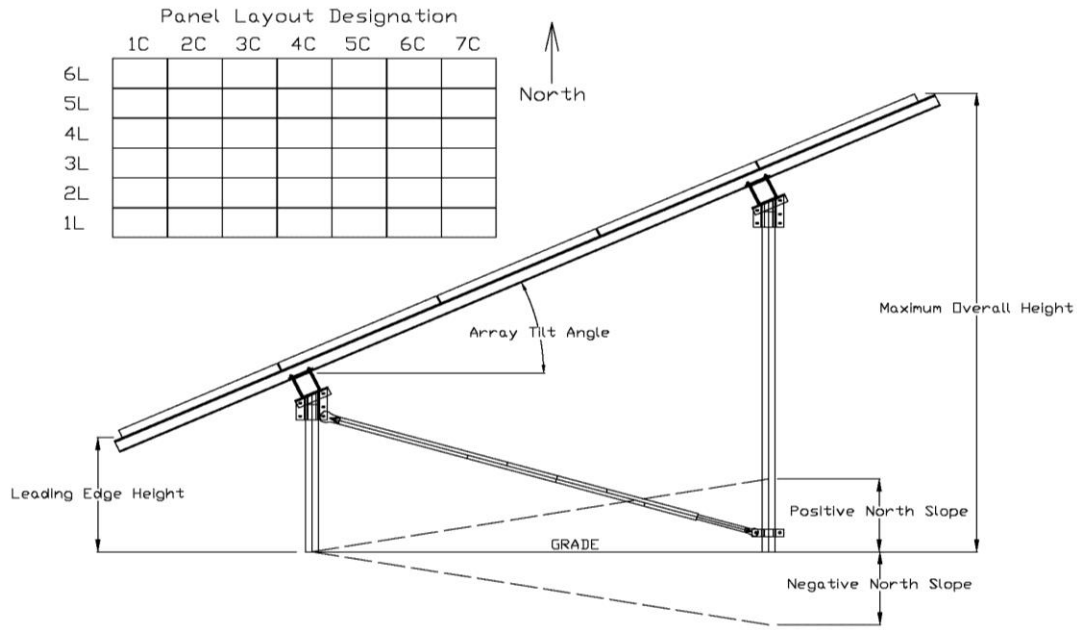

Sub-Array Type 1 Configuration

- Number of Panels per Sub-Array
- Quantity of Identical Sub-Arrays
- # Modules High in Landscape (1L up to 6L)
- # of Module Columns (East-West)
- Array Tilt Angle (25 deg Typ.)
- Required Leading Edge Height (28" Typ.)
- Required Max Overall Height (if applicable)

Sub-Array Type 2 Configuration

- Number of Panels per Sub-Array
- Quantity of Identical Sub-Arrays
- # Modules High in Landscape (1L up to 6L)
- # of Module Columns (East-West)
- Array Tilt Angle (25 deg Typ.)
- Required Leading Edge Height (28" Typ.)
- Required Max Overall Height (if applicable)

Optional Equipment Support Column (ESC)

- Number of ESC's Required - (Typ - 0, 1, 1 per array)
- ESC Location (along north pile line) - NW, NE, etc,
- Distance of ESC from Main Post -(Typ 60")
- # of U-bolts (Unistrut to Post) -(Typ - 0,4, or 8):

Additional Information